

Steenblik Park

ROUND 2 ENGAGEMENT REPORT | November 2024



**PUBLIC
LANDS**





Project Background

Located in the Rose Park neighborhood in District 1, Steenblik Park was selected to receive funding for improvements through the Parks, Trails, & Open Space General Obligation (GO) Bond, approved by voters in 2022.

In the summer of 2023, SLC Public Lands staff gathered public input during the first round of engagement to understand the park's current use, community's priorities, and desired improvements.

Based on the feedback, two concept designs were developed. SLC Public Lands conducted another round of public input, the results of which are summarized in this report, to ensure the designs captured the feedback we heard and to refine the final park design.



Who participated?

Dates

October 4 – October 31, 2024

Participation

- 161 online survey submissions
- 625 votes at events

Stakeholders

- Rose Park Community Council
- Households within a ½-mile radius of the park
- Steenblik family
- Rose Park Elementary

Zip Codes of Survey Respondents

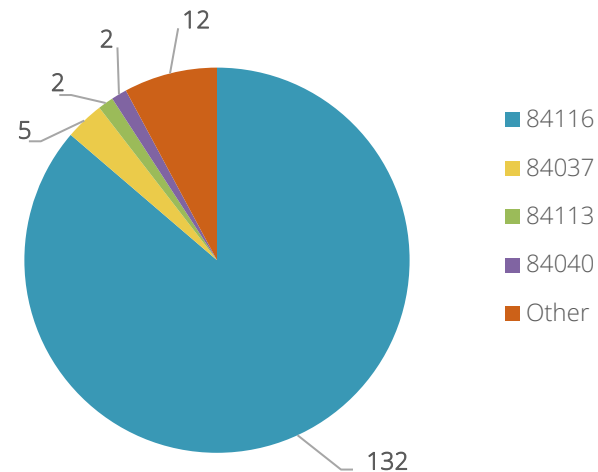

Each of the 12 responses in the "other" category varied, with only one response per zip code

How was information shared?

Canvassed

- Provided flyers within a ½ mile of the park
- Placed yard signs in the surrounding area

Online Promotion

- Facebook/Instagram posts

Community Outreach

- Rose Park Community Council
October 2, 2024
- Rose Park Elementary's Trunk or Treat
October 25, 2024
- Monster Block Party
October 26, 2024

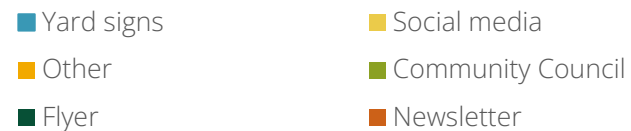
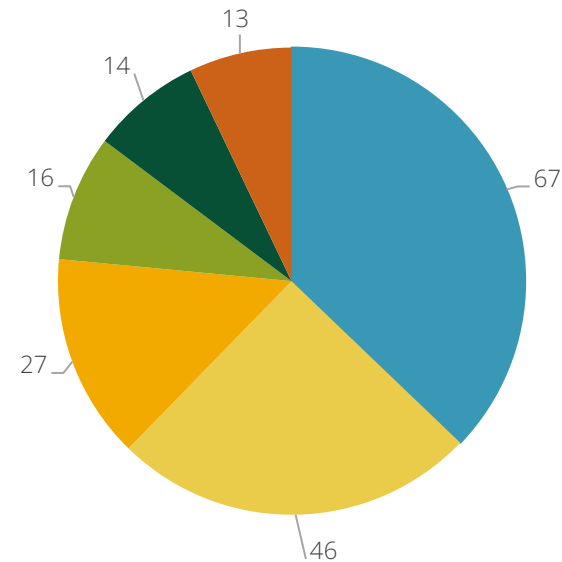

Most responses to "other" indicated they found out by word of mouth or an email from the city



Concept A

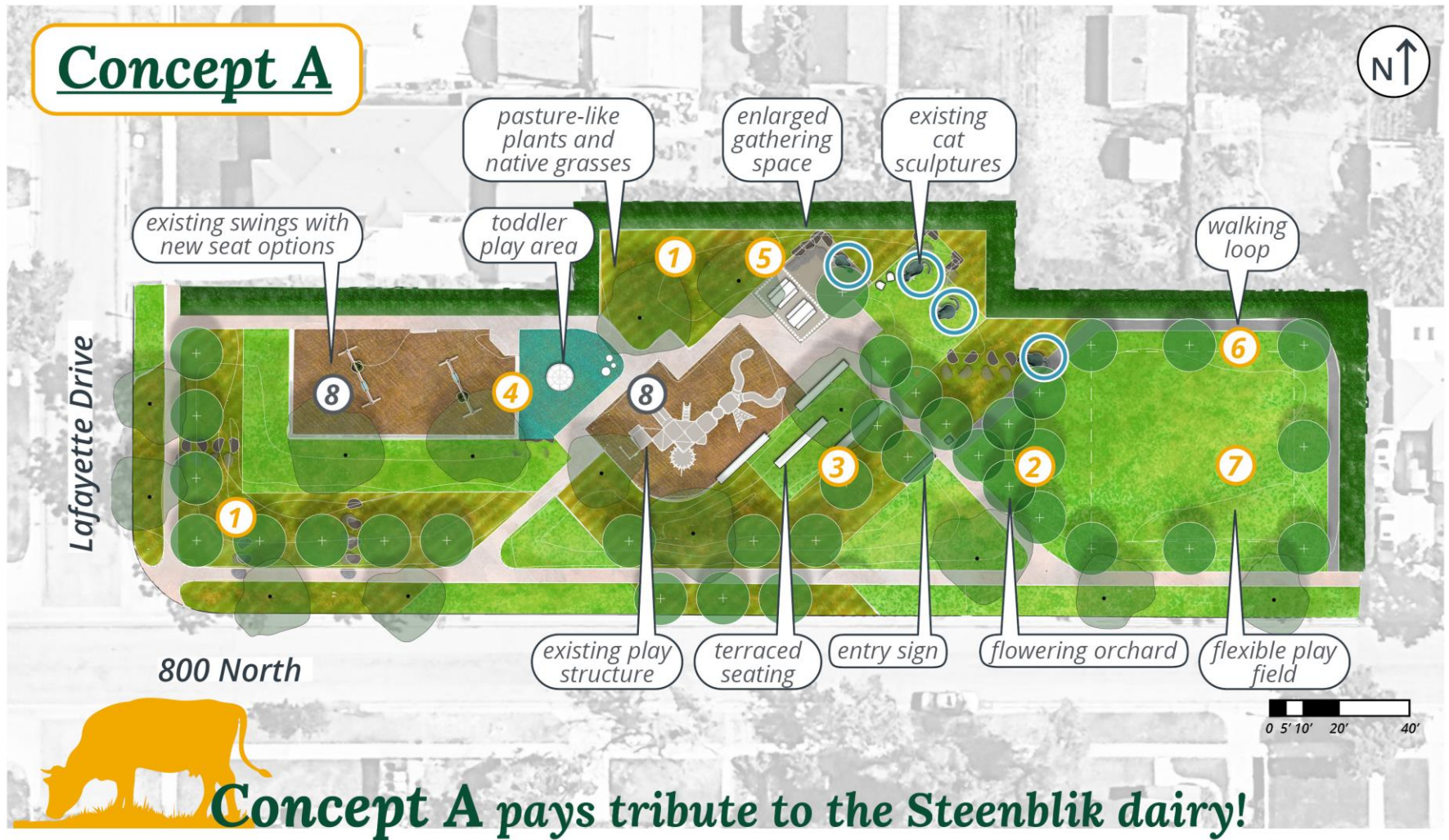

This concept adds (1) **pasture-like plants, native grasses** and (2) **an orchard of flowering trees** to the park. (3) **Terraced seating** on the hillside is flexible for picnics or watching kids play at the expanded (4) **toddler play area**. An enlarged (5) **gathering space** with brightly colored furnishings embraces the cat sculptures and (6) **a new walking loop** with new trees frames the (7) **flexible play field**.

Note: (8) The existing play structure will be updated in both concepts to complement the refreshed design, and additional solar lighting is being explored.

Concept B

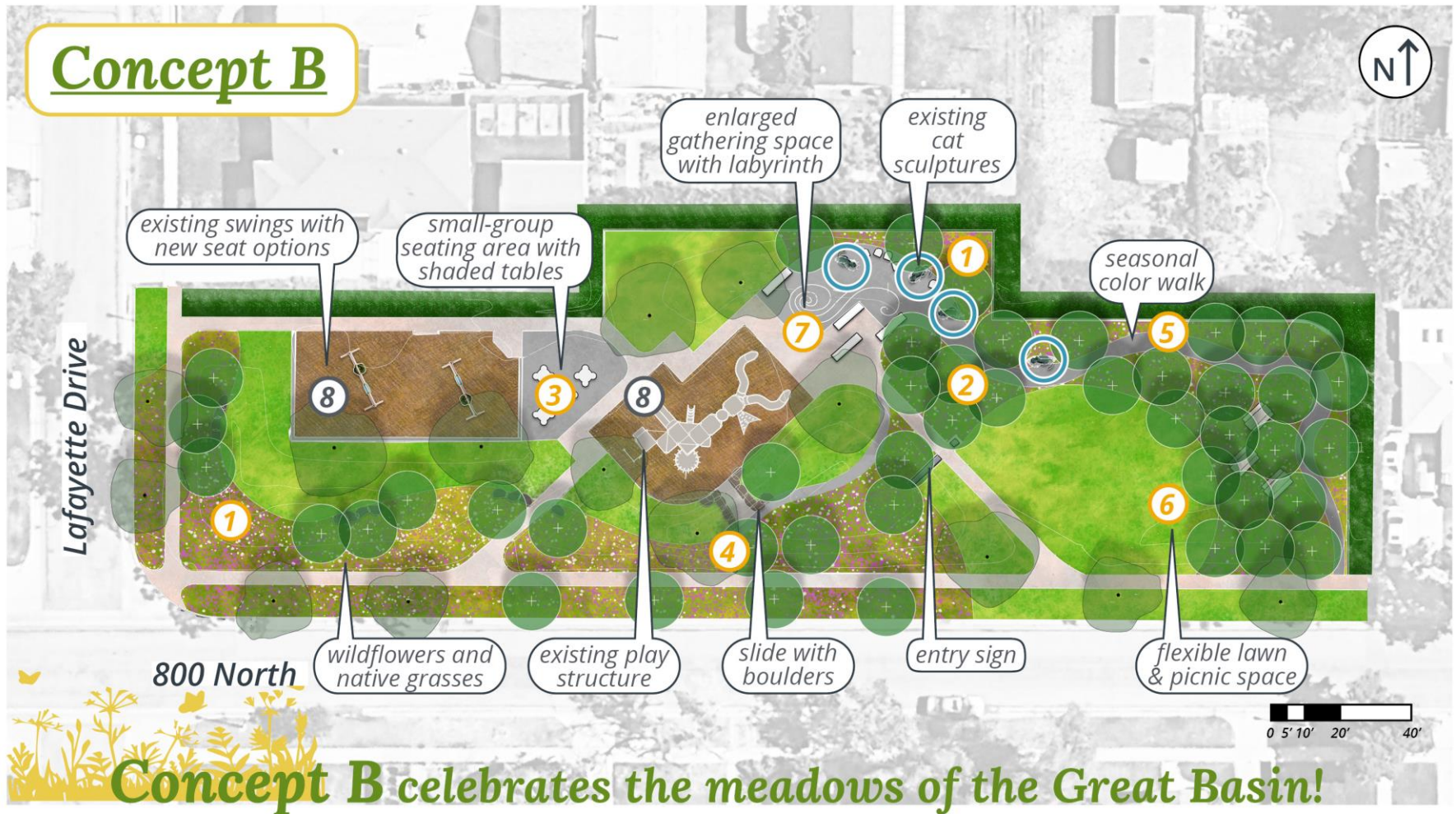

Concept B celebrates the meadows of the Great Basin!

This concept adds color to Steenblik Park using (1) **wildflowers, native grasses**, and an (2) **expanded canopy of trees**. Between the two upgraded play zones is a (3) **covered picnic area** where users can see the new toddler-sized (4) **slide with seating / climbing boulders** emerging from the hillside. A meandering (5) **seasonal walk** draws users around the (6) **flexible lawn space** to the existing cat sculptures, with a nearby (7) **labyrinth** to explore and reflect. Muted site furnishing colors will complement the cat sculptures.

Note: (8) The existing play structure will be updated in both concepts to complement the refreshed design, and additional solar lighting is being explored.

Story & Theme Proposal

but what about the cat sculptures?

Don't worry, the cats aren't going anywhere!

Concept A

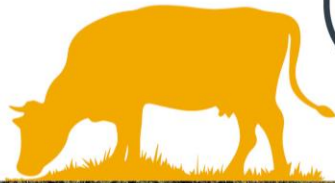

This concept pays tribute to the Steenblik Dairy story and gives a farm-like setting for the cats to live in!



Dairy-inspired play



"Dairy Pails & Bronze Cats" muted color palette

Concept B



This concept celebrates the Great Basin flowers and wildlife, giving the cats a wild garden for play!



Meadow-inspired play



"Four Seasons" vibrant color palette

Story & Theme Survey Results

Survey Results

Of the designs presented, which theme best reflects the identity and vision of the park?

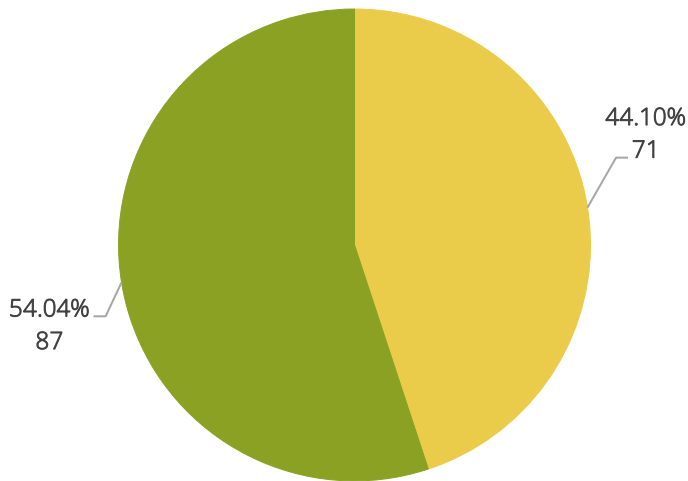

- Concept A: The Steenblik Dairy Story
- Concept B: The Meadows of the Great Basin

Which color palette do you think is most fitting for the park?

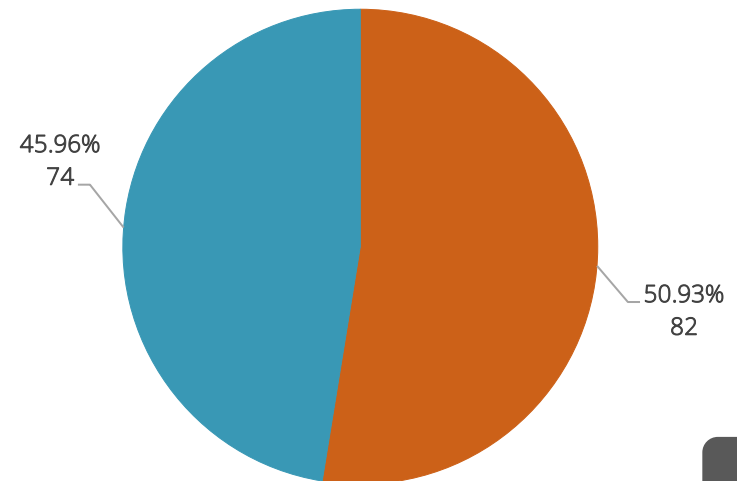

- Muted tones
- Vibrant and colorful tones

Story & Theme Comments

Open Comments

- People leaned towards the elements in the “Great Basin” theme, but noted in comments that they would like to see the Steenblik family story amplified in some way.
- Respondents love the cat statues and are pleased they are staying in the park.

How will feedback be addressed?

- Project team will find a way to pay tribute to the Steenblik family story.

“We love the cat statues. Glad to hear they aren’t going anywhere.”

“...The neighborhood has some agricultural roots, and this is a great shout-out to this area of the city and its roots.”

“As a Steenblik family member, I would like the park to keep the history but be updated and playful...My grandparents had an orchard and a large garden and living sustainably was very important to them...”

Play & Recreation Proposal



partner swing



*steel "milk drum"
djembes*



larger play lawn



*"milk pail" accessible
carousel*

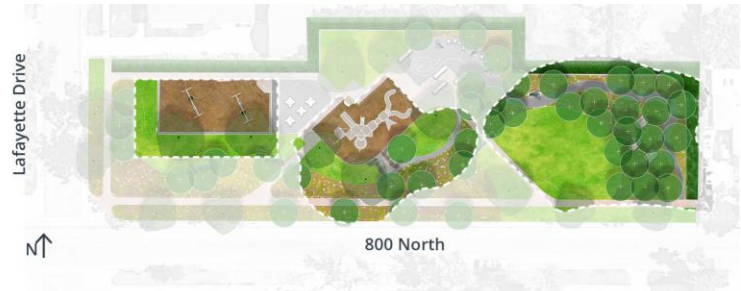

dish swing



hillside slide



*expanded tree canopy
over existing lawn*



reflection labyrinth

Play & Recreation Survey Results

Survey Results

Rank the play and recreation features in order from most favorite to least

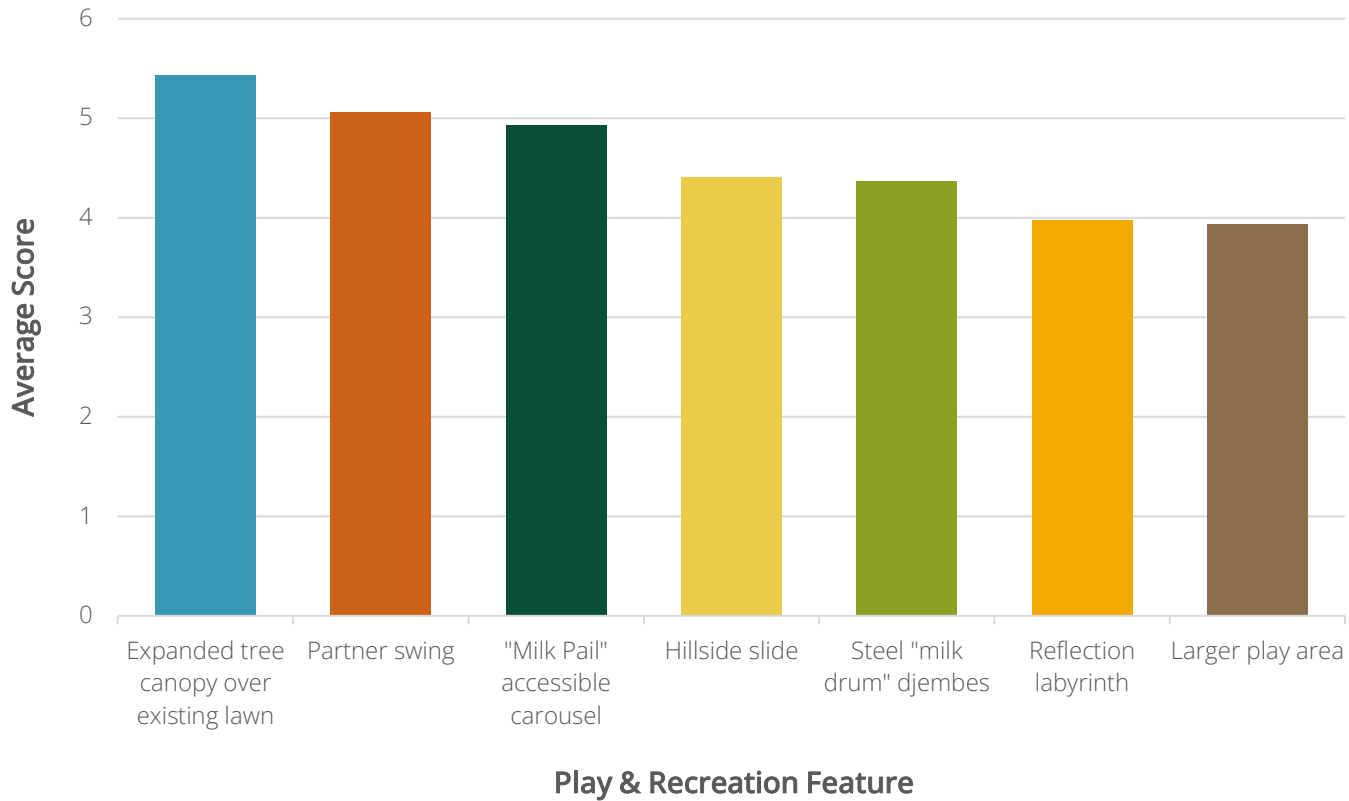

Play & Recreation Comments

Open Comments

- There was an expressed desire for updated playground equipment, and for more toddler features.
- Comments noted the need to add shade and seating near the playground.
- Several commenters noted the need for more dog amenities such as a dog bag dispenser and a drinking fountain bowl.

How will feedback be addressed?

- Playground equipment will be updated, and current safety concerns will be addressed.
- Toddler play will be implemented in the final design.
- Shade and seating will be prioritized.
- Project team will explore dog amenities that can be added.

"...I have seen kids at that park not be able to do a lot of the equipment that is already there such as the big red circle thing younger children can't get up that...."

"Having just walked there to take my toddler to play, i think it's also key to ensure spaces for stroller parking."

"...I'd also love to see shade canopy's over the playgrounds."

"Seems like more people are moving to rose park with dogs than children, did we not consider dog items?"

Plantings & Trees Proposal



small flowering orchard



sensory or culinary planting



colorful autumn trees and evergreens



wildflower mix

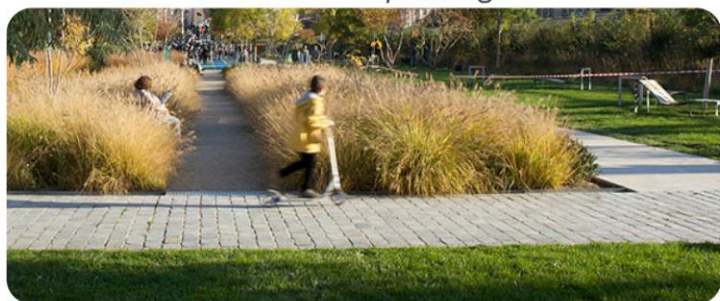

grassland meadows



pollinator meadow

Plantings & Trees Survey Results

Survey Results

Rank the planting and tree features in order from most favorite to least

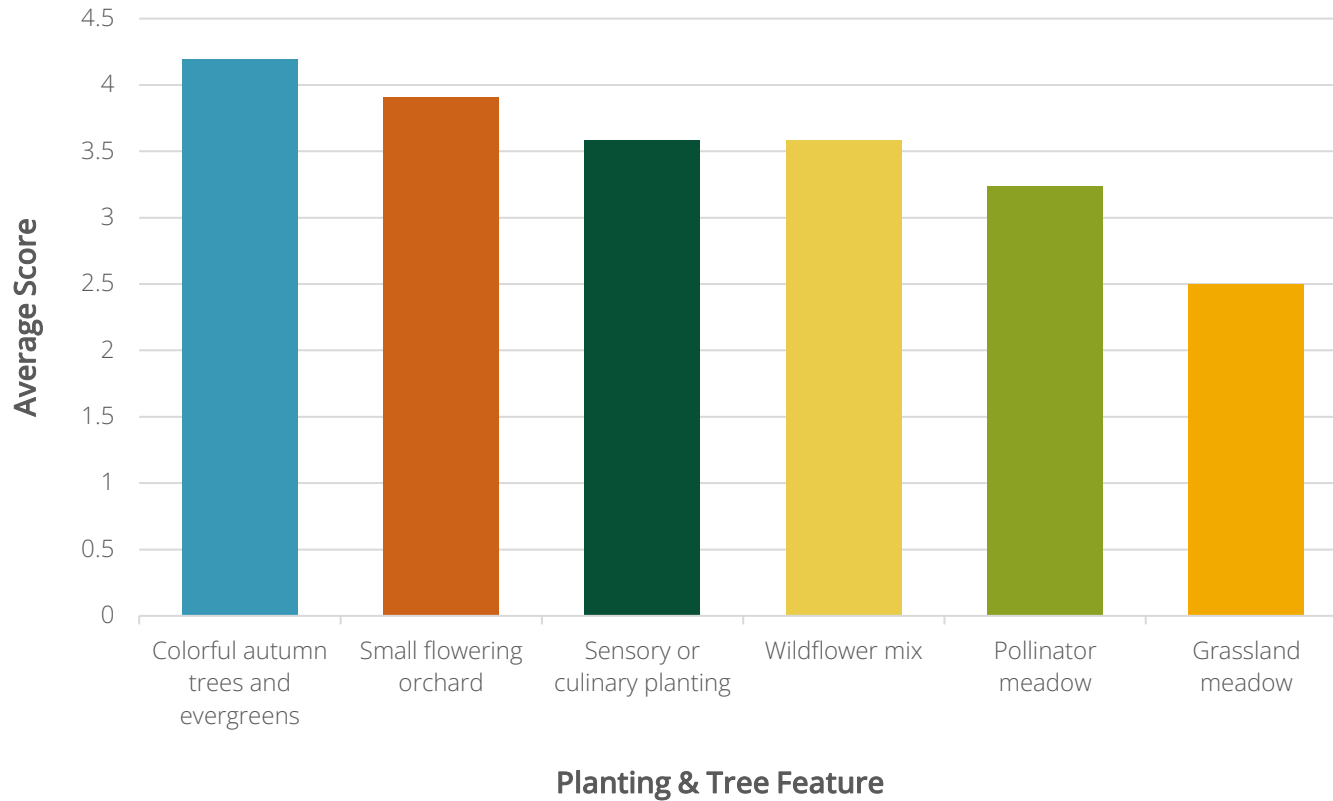

Plantings & Trees Comments

Open Comments

- Commenters expressed excitement about native plants and the need to conserve water.
- There was a desire to keep the hedges on the north fence.
- Someone noted the need for routine maintenance, including addressing the dips that are safety hazards.

How will feedback be addressed?

- Benefits of native plants:
 - Lower maintenance needs – Native plants adapt to the local climate and soil, requiring less intensive upkeep compared to non-native species.
 - Resource efficiency - Native plants require less water, fertilizers, and pesticides to thrive.

“Yes to native plants and xeriscaping!
Let’s keep water use to a minimum.”

“Shade is crucial; I like the idea of trees that can add color, movement and sound as well as dappled shade.”

“For the flowering orchard, would love to have multiple colors and time to bloom of the blossoms, emphasizing the diversity of the neighborhood. Not sure if fruit trees could be considered or not, but there are a number of other spring flowering trees which would really be beautiful.”

Seating & Gathering Proposal



larger picnic tables



overhead shade canopy



casual lounge seats



small group tables with shade



linear seat walls



playful seat blocks

Seating & Gathering Survey Results

Survey Results

Rank the seating and gathering features in order from most favorite to least

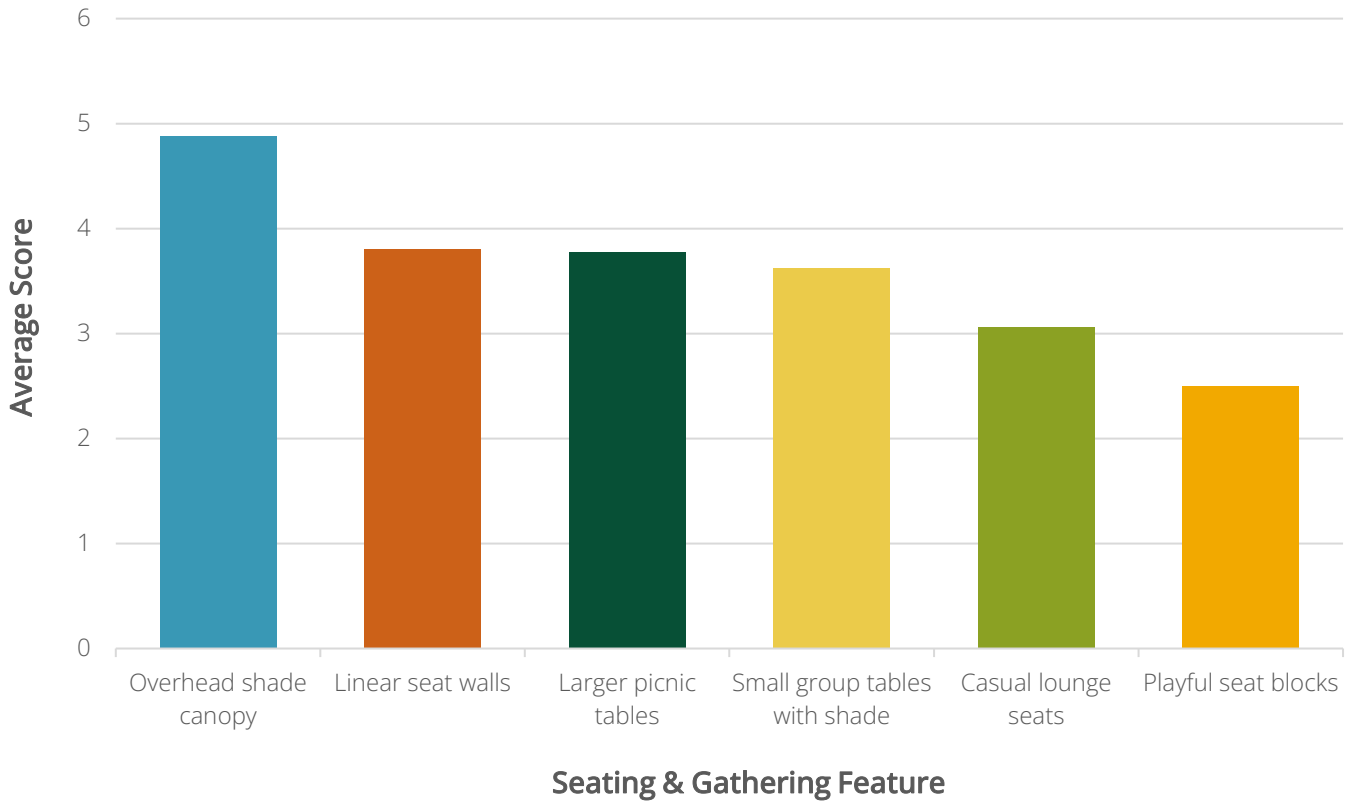

Seating & Gathering Comments

Open Comments

- A need for seating options near the playgrounds for caretakers.
- Overall, the results highlighted the importance of shade and comfortable seating areas for a variety of users.

How will feedback be addressed?

- Project team will explore adding updated picnic tables and linear seat walls.
- Shade canopies will be added.

"I would emphasize the need for comfortable seating. Some parks have had hostile architecture such as uncomfortable benches and armrests that break up the seating in order to discourage vagrancy or some such thing. That stuff is awful and should NOT be a part of this redesign. The people who use the park primarily live in the neighborhood and should have a comfortable refuge."

"I worry the lounge chairs would just become a hangout for homeless individuals."

Additional Information

Next Steps

Public Lands staff will consult with technical experts, consultants, landscape architects, and maintenance supervisors to adjust the final design of the park based on feedback received. Once the design is finalized, Public Lands will go out to bid to select a contractor.

Construction is tentatively expected to begin in 2026.

Project Website

Visit the project website slcparks.com/Steenblik to:

- Sign up for project updates
- Read the Round 1 Community Engagement Report
- Learn more about the project!

Tentative Project Schedule



Appendix 1: Comment Boards



Comment boards used at events to collect feedback

Appendix 2: Social Media Posts

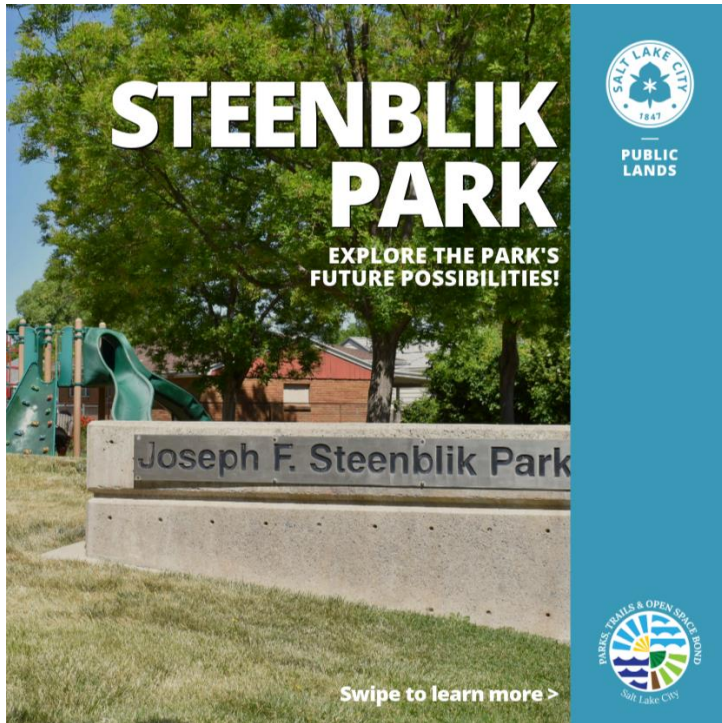

Social media posts created for Facebook and Instagram

Appendix 3: Yard Signs

View the possibilities for **STEENBLIK PARK**



You shape what comes next!

We asked you how Steenblik Park could be more enjoyable and listened to your feedback.

Now, check out the designs and weigh in!



Get involved!

- » Chat with us at events
- » Take the survey

Learn more!

For more details, visit the website



[myparkvision.com/
GO_BondParks](https://myparkvision.com/GO_BondParks)

Yard signs placed in the park and in the neighborhood

Appendix 4: Flyer

View the possibilities for Steenblik Park

In the summer of 2023, we asked for your input on improvements you'd like to see at Steenblik Park.

Based on your feedback, we've created a few park designs. Now, **it's your turn to weigh in!**



Get involved!

- »» Share your ideas by completing the survey.
- »» Chat with us at events
- »» Visit the link or scan the QR code to get started!



myparkvision.com/steenblikpark



Flyer used for canvassing

Steenblik_proposed designs

Guiding Goals

Rank the goals in order of importance to you.

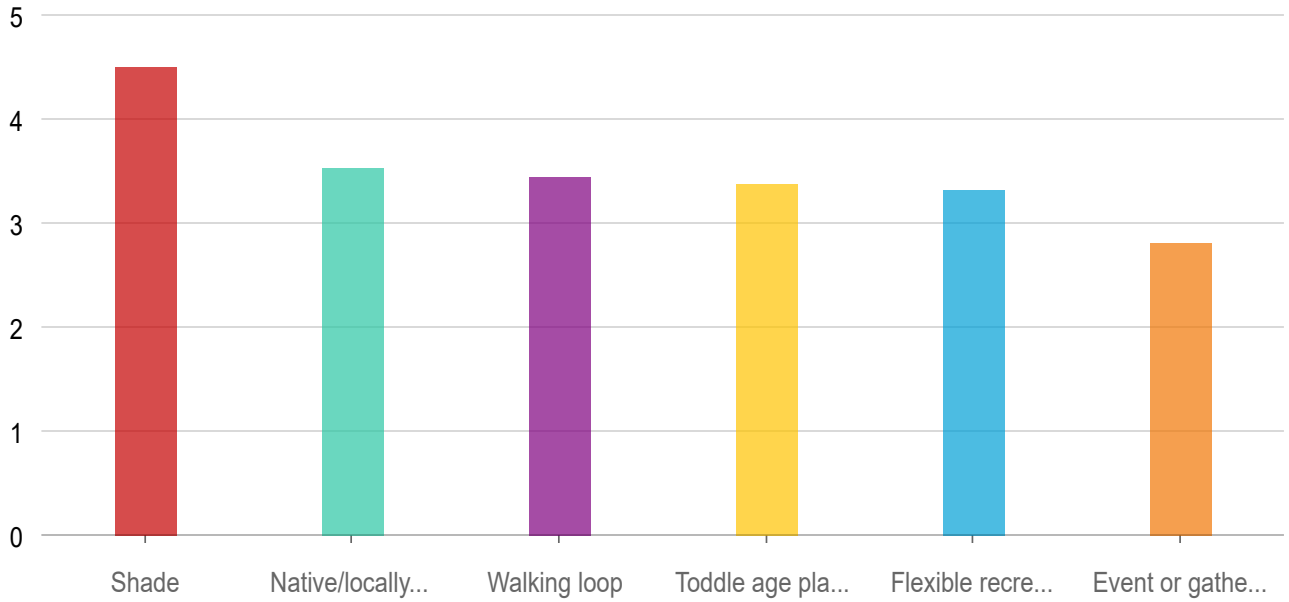

Rank	Answers	1	2	3	4	5	Average score
1	Shade	26.03% 38	32.19% 47	21.23% 31	10.96% 16	6.16% 9	4.51 5
2	Native/locally adapted planting	17.81% 26	17.12% 25	15.75% 23	12.33% 18	23.97% 35	3.53
3	Walking loop	16.44% 24	13.01% 19	21.92% 32	17.12% 25	10.27% 15	3.45 31
4	Toddle age play	23.29% 34	8.9% 13	13.01% 19	15.75% 23	15.75% 23	3.38
5	Flexible recreation	6.16% 9	20.55% 30	15.07% 22	26.03% 38	21.92% 32	3.32 15
6	Event or gathering space	10.27% 15	8.22% 12	13.01% 19	17.81% 26	21.92% 32	2.81

Let's explore the main features of the designs now!

- Of the designs presented, which theme best reflects the identity and visio...

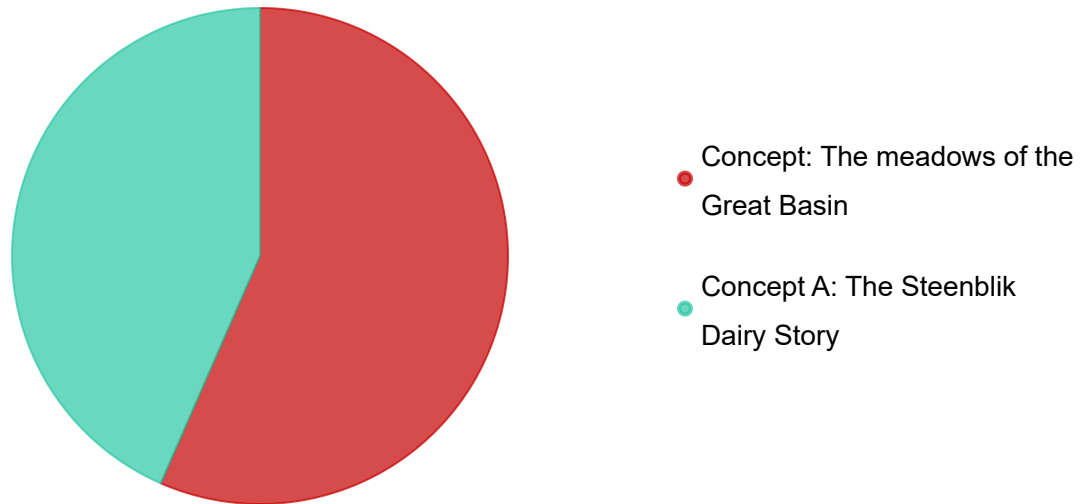
**Answers****Count****Percentage**

Concept: The meadows of the Great Basin

82

55.41%

Concept A: The Steenblik Dairy Story

63

42.57%

Answered: 145 Skipped: 3

- Which color palette do you think is most fitting for the park?

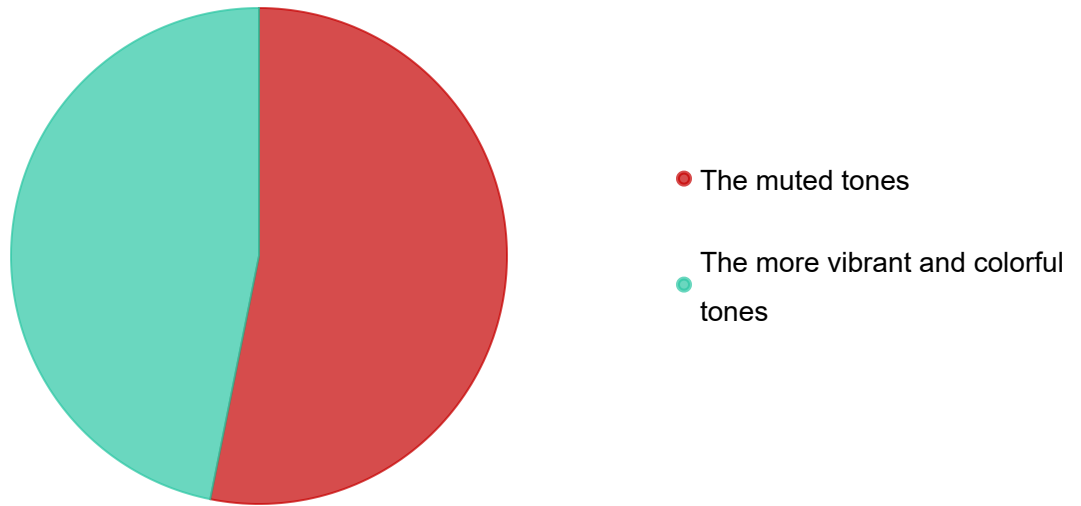

Answers **Count** **Percentage**

The muted tones	76	51.35%
The more vibrant and colorful tones	67	45.27%

Answered: 143 Skipped: 5

Play and Recreation

Rank the play and recreation features in order from most favorite to least

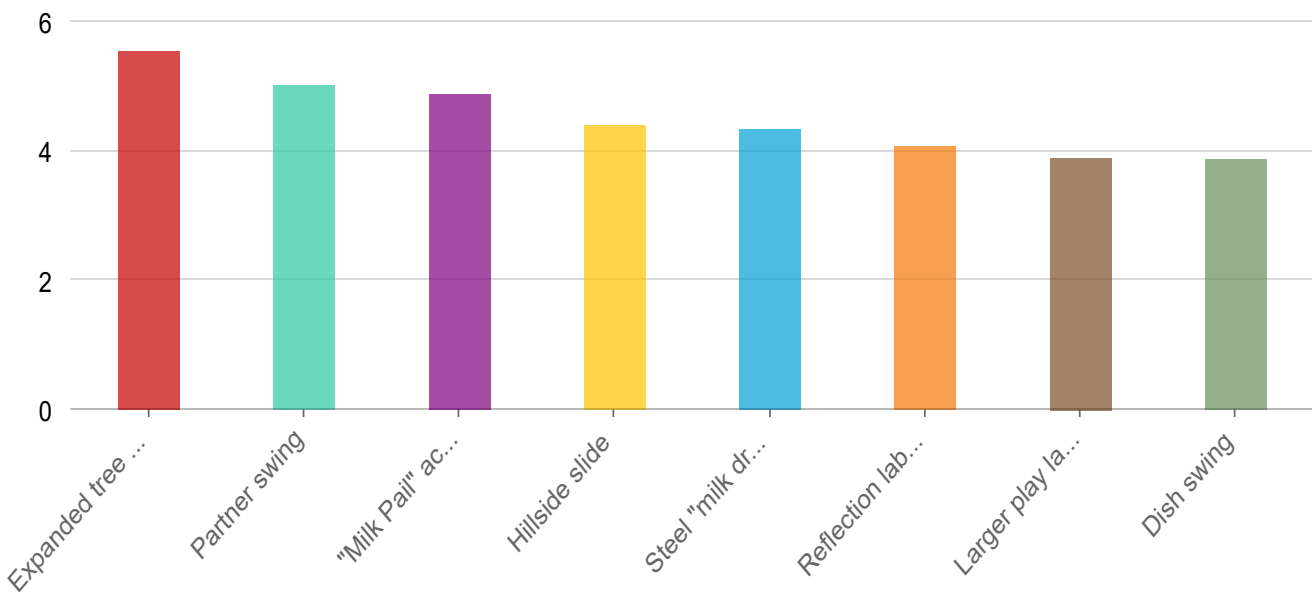

Rank **Answers** **1** **2** **3** **4** **5** **Average score**

1	Expanded tree canopy over existing lawn	37.24% 54	11.03% 16	8.28% 12	8.97% 13	6.9% 10	5.52% 8	17.93% 5.54	26
2	Partner swing	6.9% 10	25.52% 37	11.72% 17	16.55% 24	13.1% 19	13.1% 19	5.01	
3	"Milk Pail" accessible carousel	15.17% 22	10.34% 15	13.1% 19	16.55% 24	18.62% 27	11.72% 17	8.28% 4.88	12
4	Hillside slide	17.24% 25	8.97% 13	7.59% 11	12.41% 18	10.34% 15	17.24% 25	4.40	
5	Steel "milk drum" djembes	6.21% 9	11.03% 16	24.14% 35	11.03% 16	8.28% 12	12.41% 18	9.66% 4.34	14
6	Reflection labyrinth	9.66% 14	19.31% 28	8.97% 13	6.21% 9	11.03% 16	6.9% 10	4.07	

Answered: 145 Skipped: 3

Planting and Trees

Rank the planting and tree features in order from most favorite to least...

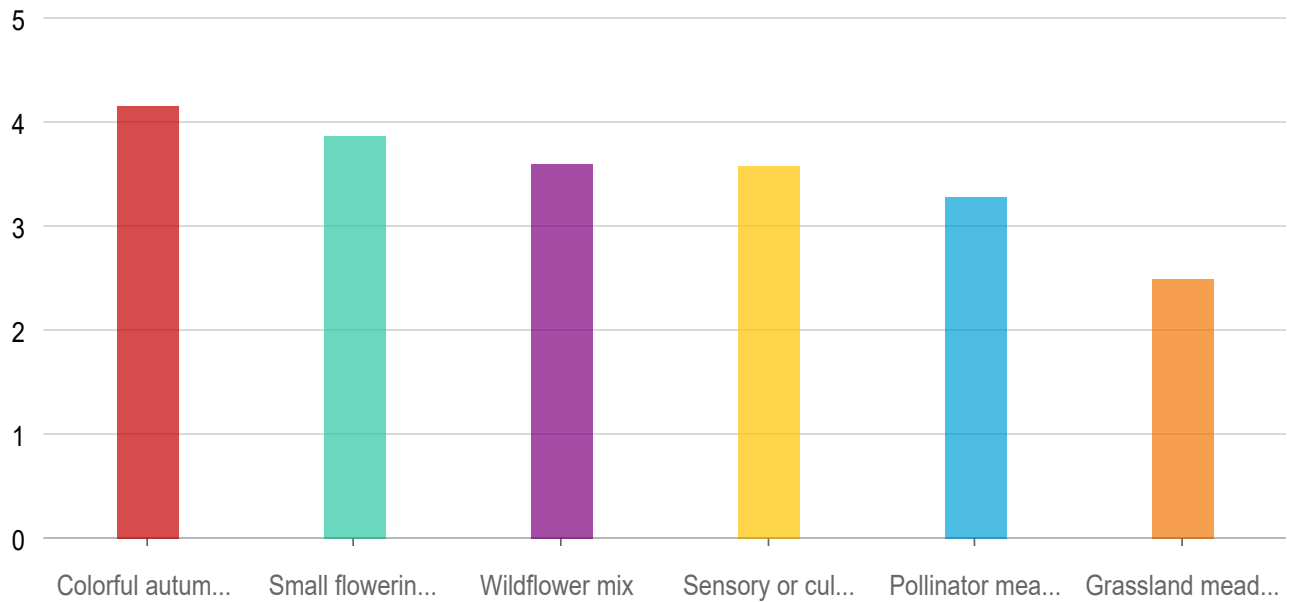

Rank	Answers	1	2	3	4	Average score
1	Colorful autumn trees					4.16

		32.87%	14.69%	13.29%	20.28%	12.59%	
2	and evergreens Small flowering orchard	47	21	19	29		3.87
3	Wildflower mix	13.29%	28.67%	17.48%	18.88%	16.08%	5.59%
		19	41	25	27	23	3.60 8
4	Sensory or culinary planting	13.99%	17.48%	22.38%	14.69%	23.78%	3.58
		20	25	32	21		
5	Pollinator meadow	14.69%	14.69%	28.67%	11.89%	16.08%	13.99%
		21	21	41	17	23	3.29 20
6	Grassland meadows	19.58%	18.88%	8.39%	7.69%	14.69%	2.50
		28	27	12	11		
		5.50%	5.50%	9.70%	20.57%	10.70%	25.00%

Answered: 143 Skipped: 5

Seating & Gathering

Rank the seating and gathering features in order from most favorite to least...

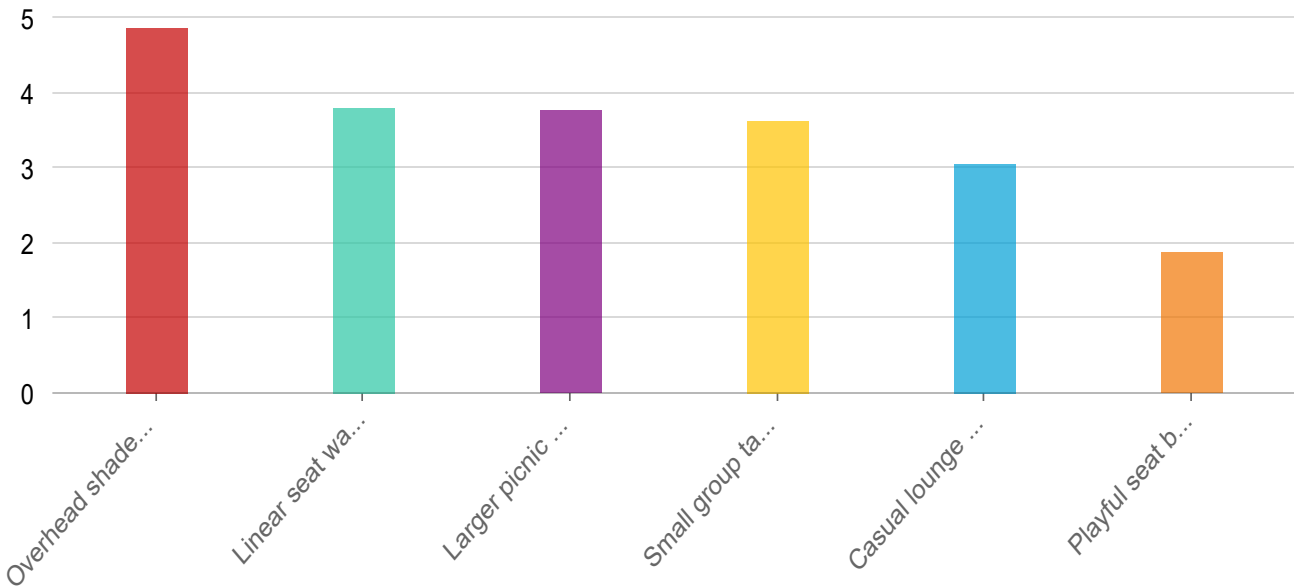

Rank	Answers	1	2	3	4	Average score	
1	Overhead shade canopy	44.76%	20.98%	18.88%	9.79%	2.8%	2.8%
		64	30	27	14	4	4
							3.80

Well if u put some gym machines that was so cool and more people going to the park	1
We should add bathrooms!not many kids use the bathroom before going and need to go when they arrive we should add bathrooms!	1
We need to remember the history of the dairy and the community that came with the dairy.	1
We love the cat statues. Glad to hear they aren't going anywhere.	1
We are the Steenblik descendants and we love the park	1
Updated playground for kids	1
This is a kids park more than anything. I hardly see adults by themselves although they should be considered as well. Better seating is key for that demographic but definitely need young kid friendly is most important	1
There are many people with dogs in this neighborhood. If we could fence off some of the large grass area on the east lawn for dogs, that would be incredible and very appreciated for our large dog community. Something similar to the small dog area that pioneer park has. Thank you!	1
The current play structure is outdated and not particularly safe for small kids because there is a ledge with a large drop off that you have to climb down (or fall down) to get over to the side with the slide. WE NEED A NEW STRUCTURE. A new structure is significantly more important than so much grass and flowers.	1
The car park has always been a nice calm park where people come to relax. I'd like to keep it that way a hidden gem tucked into the community.	1
test	1
Shade and play are top priorities! Be playful and creative in the design, we have an opportunity to be unique.	1
Seems like more people are moving to rose park with dogs than children, did we not consider dog items? Prefer enhancing a more natural beauty for the park, making it a nice oasis area to walk through.	1
public restrooms! it will be impossible to have any type of larger gathering without people being able to go the bathroom.	1
Please use native trees and plants that will grow in Utah without much water. If you must plant lawn please consider using a mix that grows with excess water and that does not require weekly mowing.	1

<p>Please prioritize toddler spaces. With this, you'll need space for adults to care for the children. Having just walked there to take my toddler to play, i think it's also key to ensure spaces for stroller parking. I frequently see smaller kids at this park and it's a great amenity for families. I appreciate the space for congregation and the beautification that will be made.</p>	1
<p>Please preserve the hedges along the north side fence. And more routine maintenance for the grass (it gets really weedy and hard to walk on). And some holes/dips in the lawns that have become a safety hazard.</p>	1
<p>Plan now for homeless people and their abusive takeover, like they are doing in Riverside Park north Bowery.plan ahead for enforcing rules and laws. Thank you,</p>	1
<p>One of the biggest things I have found with a toddler is that the material under a play structure can make a HUGE impact on the quality of play. Mulch, rocks, etc. may be cheaper but are very uncomfortable for children who trip and fall more often. They also get kicked around and pushed away from the bases of slides and swings, which can make the drop from the slide edge so high a small child can't use it. Murray Park has an amazing, bouncy, solid rubber-type base that does not move. I would LOVE to see that material or something similar used. I love this park and want to come more often!! I also work for an architecture firm that has a landscape department so if you do want or need that on this or any other projects I would love to get involved!! [REDACTED]!</p>	1
<p>No multilingual signage</p>	1
<p>Need to get rid of the cat statues they are to big and ugly</p>	1
<p>My son (3 years old) really enjoys the parks that have interesting but safe climbing features as well as the interactive nature sound spinners and speakers you can talk across the playground. Just some suggestions to integrate if possible. Thank you!</p>	1
<p>My hope for this pocket park is a bit of diversity, intimate seating, and that the design honors the history of the dairy!</p>	1
<p>Mr. Steenblik was a great man and an influence to my family. Keep the name</p>	1

Man, I am so happy about the cat sculptures. I think that adding a fourth larger cat sculpture. Like 2 -3 times larger would be really cool. I also like the idea of soft warm lighting illuminating the cats, and I guess the rest of the park too. I also like the fact that there really aren't too many homeless people at this park, it's nice. Lots of children play here and that's nice. I will say that although homeless people aren't there often there is a man who parks his camper trailer on the side of the park for weeks at a time and I'm pretty sure he steals lime scooters. So I'm not really sure if he's a folk hero or homeless... but ya know. I uh just can't leave that out. See something say something, ya know. I also am really happy that you guys give us 1000 characters to make full, well articulated responses. I don't truly believe that I could fit all of the love and affection for the cat sculptures into a shorter character amount. Anyways, thank you for all that you do meow.

Love the theme associated with the old Steenblik Dairy! Thank you for considering the historic aspect in the redesign options! The neighborhood has some agricultural roots, and this is a great shout out to this area of the city and its roots. For the flowering orchard, would love to have multiple colors and time to bloom of the blossoms, emphasizing the diversity of the neighborhood. Not sure if fruit trees could be considered or not, but there are a number of other spring flowering trees which would really be beautiful. Would love to have a placard share a bit more information about Joseph F Steenblik. Maybe a picture of him with a cow. Love the idea of a walking path around the boundary of the park.

Love the idea of honoring the legacy of the dairy, but also excited about the native plant opportunities.

Looking forward to the redesign. My boys love playing at Steenblik park. Would love to have the dish swing and be more toddler friendly.

Less dairy theme

I'm excited for more shade and pollinator/native plants.

I would like for the playground to be replaced for something more kid friendly. I have seen kids at that park not be able to do a lot of the equipment that is already there such as the big red circle thing younger children can't get up that. And it makes them so sad when they can't figure it out especially because if you can't get up the red thing you can't really do the two big slides that is at the end of the play structure. So I think that you should make the play structure more kid friendly.

I would emphasize the need for comfortable seating. Some parks have had hostile architecture such as uncomfortable benches and armrests that break up the seating in order to discourage vagrancy or some such thing. That stuff is awful and should NOT be a part of this redesign. The people who use the park primarily live in the neighborhood and should have a comfortable refuge. I'm excited to see the new playground design. While the current design has been fun for our kids, it is clear that much better equipment has been built in other parts of the city. There have been considerable advances in what is possible for a kids playground. Shade and trees!

I think these concepts are great! Nice work incorporating everything. The only suggestion might be more permanent waste bins. There is often trash left around the park. Thank you!	1
I think a lot of younger children play at this park since there is a school nearby. And being tucked into the neighborhood is nice for mothers with young children	1
I really like the toddler play area - this park is primarily a play space and adding the amenities for younger kids will be a great asset. Shade is crucial; I like the idea of trees that can add color, movement and sound as well as dappled shade.	1
I love the direction! A carousel is not a great toddler play area, if that's the plan. If valuable space is used on a toddler play area, it should have smaller climbing apparatuses and slides just like the big one.	1
I like concept B design better but I like keeping the dairy farm story and concept. That's where it came from so I believe it should stay:)	1
I hope the safety aspect has been addressed. There doesn't seem to be a lot for toddler age children to do. I worry the lounge chairs would just become a hangout for homeless individuals.	1
Have trash bins available along with a dog poop bag dispenser for people walking their dogs in the area.	1
As long as the Steenblik sign stays up its good. A little description of the history on the back of the sign would be cool too.	1
As a Steenblik family member, I would like the park to keep the history but be updated and playful. I would love to see more people and kids using the park. My grandparents had an orchard and a large garden and living sustainably was very important to them. I would love to see an orchard and edible plants in the park to reflect that.	1
Add shade and lots of seating around the playgrounds. As a mom with little kids I need shade to sit in close by to my kids. I'd also love to see shade canopy's over the play grounds.	1
A nice plaque about history and nature in the area would be great	1

Answered: 46 Skipped: 102

○ **How did you learn about this project?**

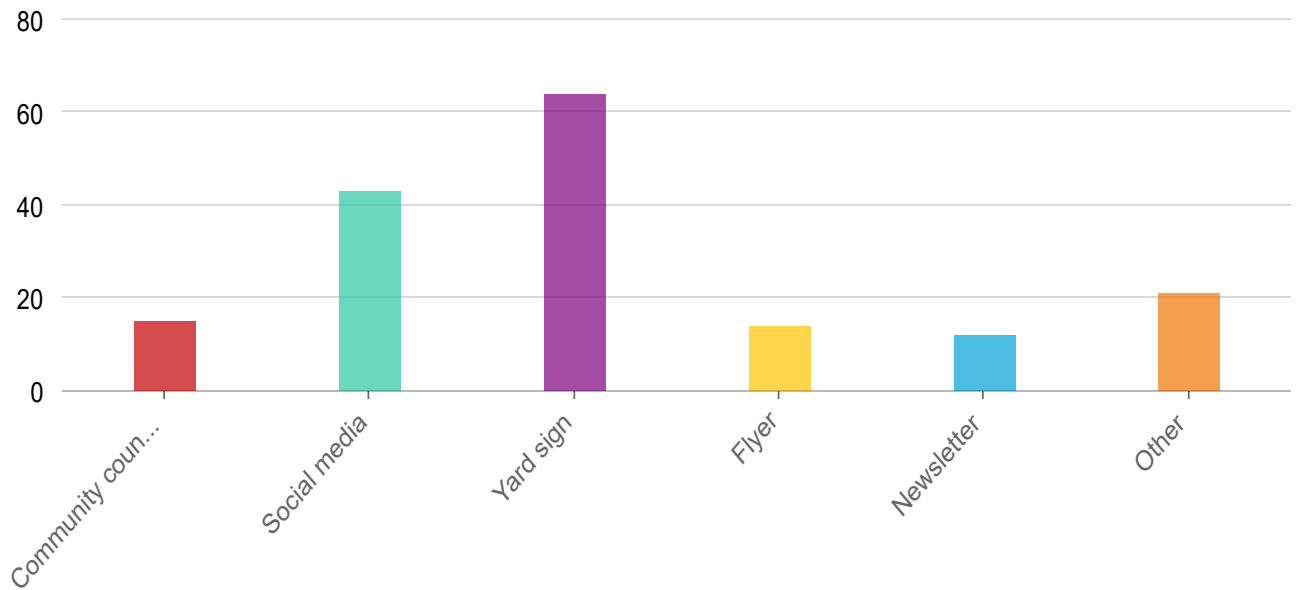

Answers **Count** **Percentage**

Answers	Count	Percentage
Community council	15	10.14%
Social media	43	29.05%
Yard sign	64	43.24%
Flyer	14	9.46%
Newsletter	12	8.11%
Other	21	14.19%

Answered: 143 Skipped: 5

o **What is your zip code?**

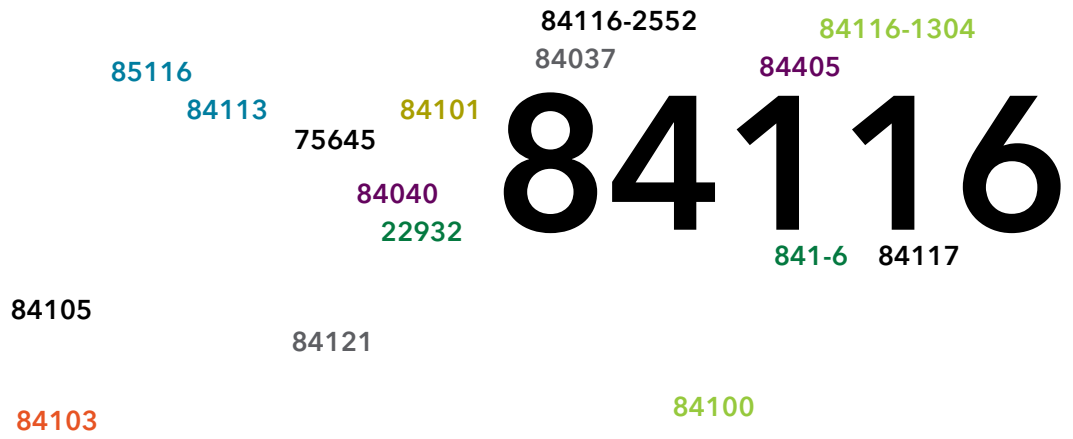

Word **Count**

Word	Count
84116	122
84037	3
84040	2
84113	2
22932	1
75645	1
84100	1
84101	1
84103	1
84105	1
84117	1
84121	1
84405	1
85116	1

841-6	1
84116-2552	1
84116-1304	1

Answered: 142 Skipped: 6